

5 Beedles Close, Aqueduct TF4 3SQ

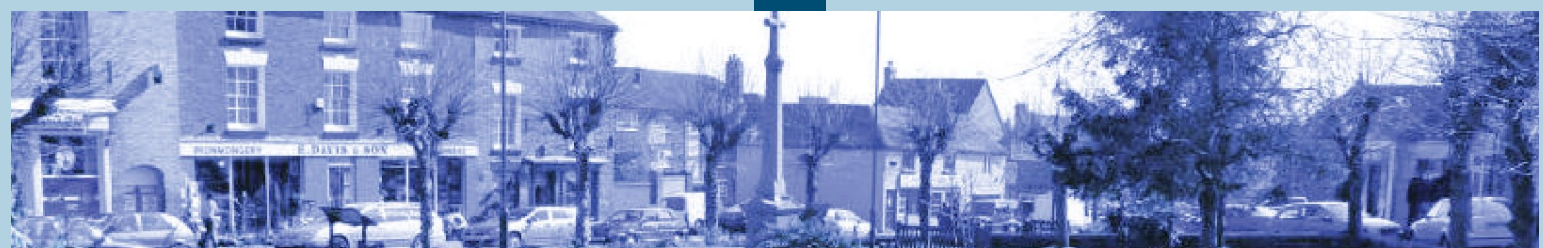

£ 1 6 9 , 9 5 0 r e g i o n

Three bedroom property situated close to local schooling and within easy reach of amenities. The accommodation includes lounge, kitchen and dining room with double doors out to the rear. The first floor offers three bedrooms and a family bathroom. Driveway parking and enclosed garden to the rear. Ideal first time buy or rental investment.

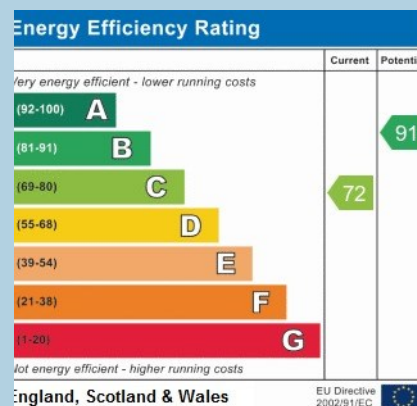





Ground Floor

Approx. 32.6 sq. metres (350.6 sq. feet)

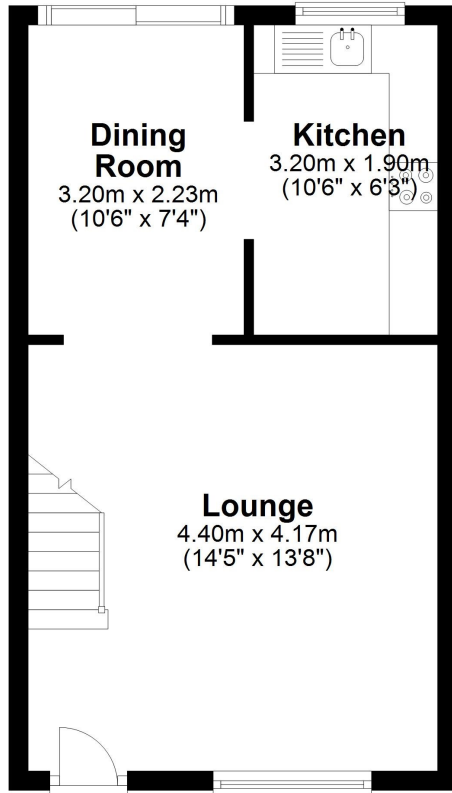

First Floor

Approx. 32.6 sq. metres (350.6 sq. feet)

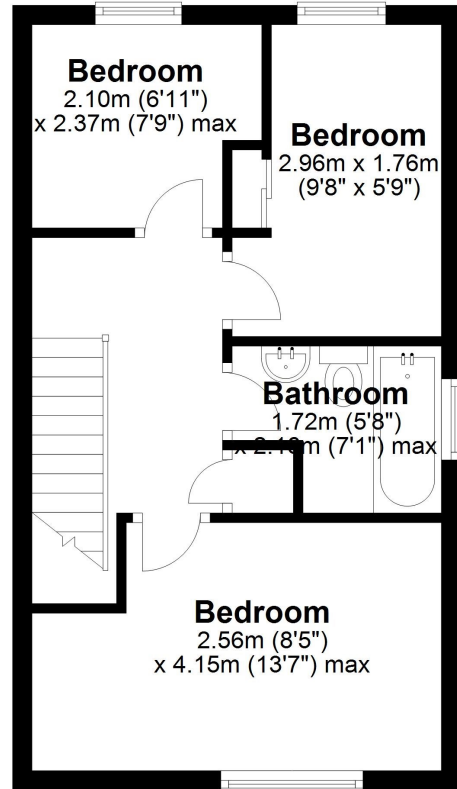

Total area: approx. 65.1 sq. metres (701.2 sq. feet)

Tenure Freehold **Council tax** Band B

Fixtures & Fittings Where specifically mentioned in these sales particulars are included in the sale price.

N.B Please note, that none of the services, heating systems or any appliances at this property have been tested, therefore no warranty can be given or implied as to their working order. These particulars do not constitute or form a part of any contract. Whilst Harwood Estate Agents and their employees take every care in the preparation of these particulars they hereby state both on behalf of themselves and the vendor that no intending purchaser should rely on any of the statements of representation of fact and the intending purchaser should make his/her own inspection and enquiries in order to satisfy himself/herself of their authenticity and no responsibility is accepted for any error or omission herein.

Details prepared : 20th September 2021